

ADDENDUM NO. 2  
MAINTENANCE BUILDING  
NATIONAL PARK COLLEGE  
HOT SPRINGS, ARKANSAS  
Project No. 23058

October 30, 2023

Lewis, Elliott, McMorran, Vaden,  
Ragsdale & Woodward, Inc.  
11225 Huron Lane, Suite 104  
Little Rock, AR 72211  
Telephone: (501) 223-9302

The proposed Contract Documents, dated September 6, 2023, have been modified as follows:

Pertaining to the Drawings:

- Item #1: Sheet ES1.0: Refer to revised Keyed Electrical Site Note 4.
- Item #2: Sheet E2.2:
- a. Refer to revised Keyed Power Notes 3 and 7.
  - b. Added keyed notes 3,7, and 8 to data room on Power Plan.

END OF ADDENDUM NO. 2

GENERAL ELECTRICAL SITE NOTES(THIS SHEET ONLY)

- 1. THE SECONDARY DITCH, SECONDARY CONDUITS WITH ¼ FULL ROPE, SECONDARY CONDUCTORS, ARE TO BE PROVIDED AND INSTALLED BY THE ELECTRICAL CONTRACTOR. PROVIDE LONG SWEET GALVANIZED RIGID STEEL ELBOWS FOR THE SECONDARY. PROVIDE ALL TRENCHING, BACKFILLING, SAWCUTTING AND PATCHING OF HARD SURFACES, ECT FOR CONDUITS. THE POLE TOP TRANSFORMER AND PRIMARY CONDUCTORS TO ARE PROVIDED AND INSTALLED BY UTILITY COMPANY.
- 2. SECONDARY CONDUITS SHALL BE INSTALLED A MINIMUM OF 24" BELOW GRADE USING 24" RIGID ELBOWS ENGAGED IN 4" COVER OF CONCRETE (SLURRY FILL)
- 3. ELECTRICAL CONTRACTOR IS RESPONSIBLE FOR ALL COSTS OF INSTALLATION AND CONNECTING THE ELECTRICAL SERVICE CONDUITS. COORDINATE CONNECTION TO EXISTING OVERHEAD LINES WITH ENTERGY ATTN: SCOTT DANNELLY.
- 4. ELECTRICAL CONTRACTOR IS RESPONSIBLE FOR ALL COSTS OF INSTALLATION AND CONNECTING ATIT SERVICE CONDUITS. COORDINATE WITH DERRICK JOHNSON.

KEYED ELECTRICAL SITE NOTES(THIS SHEET ONLY)

- ① SECONDARY ELECTRICAL SERVICE CONDUIT, REFER TO GENERAL NOTE 1
- ② IDENTIFY OUTDOOR UNDERGROUND LINES WITH CONTINUOUS STRIP OF PLASTIC UTILITY MARKER. TAPE SHOULD STATE AT REGULAR INTERVALS: "CAUTION (STATE UTILITY) PIPE BELOW". INSTALL TAPE ONE FOOT DIRECTLY ABOVE PIPE BEFORE BACKFILLING TO GRADE.
- ③ PROPOSED LOCATION FOR NEW UTILITY COMPANY POLE AND POLE TOP TRANSFORMER
- ④ PROVIDE 2-2" CONDUITS FROM SERVER ROOM TO UTILITY EASMENT AT POWER POLE ②
- ⑤ JUNCTION BOX FOR POWERED GATE, VERIFY REQUIREMENTS WITH OWNER
- ⑥ COORDINATE FINAL LOCATION OF EXTERIOR PANEL (PANEL P3) IN THE FIELD WITH FINAL LOCATION OF RELOCATED BUILDING.
- ⑦ ELECTRICAL CONTRACTOR TO PROVIDE AND INSTALL APPROXIMATELY 1200' OF 3" CONDUIT FROM NEW PULL BOX OUTSIDE OF GATE TO ADULT ED BUILDING (BUILDING 20) ON NPCC CAMPUS. A NEW IN GRADE PULL BOX SHALL BE PROVIDED AND INSTALLED AT APPROXIMATELY 300' INTERVALS. TERMINATE THE CONDUIT AT AN EXTERIOR SURFACE MOUNTED NEMA 3R 12"x12"x6" JUNCTION BOX. ELECTRICAL CONTRACTOR SHALL ALSO PROVIDE AND INSTALL A 6 PAIR MULTIMODE FIBER CABLE AND A 25 PAIR PHONE CABLE IN THE 3" CONDUIT.

ELECTRICAL SITE PLAN LEGEND

- OHE --- OVERHEAD ELECTRIC
- UGE --- UNDERGROUND ELECTRIC
- EX-OHE --- EXISTING OVERHEAD ELECTRIC
- PP EXISTING POWER POLE
- PP POWER POLE
- QUAZITE BOX #PG1824 OR EQUIVALENT WITH COVER

UTILITY CONTACTS:

ENTERGY SCOTT DANNELLY 501-620-5104

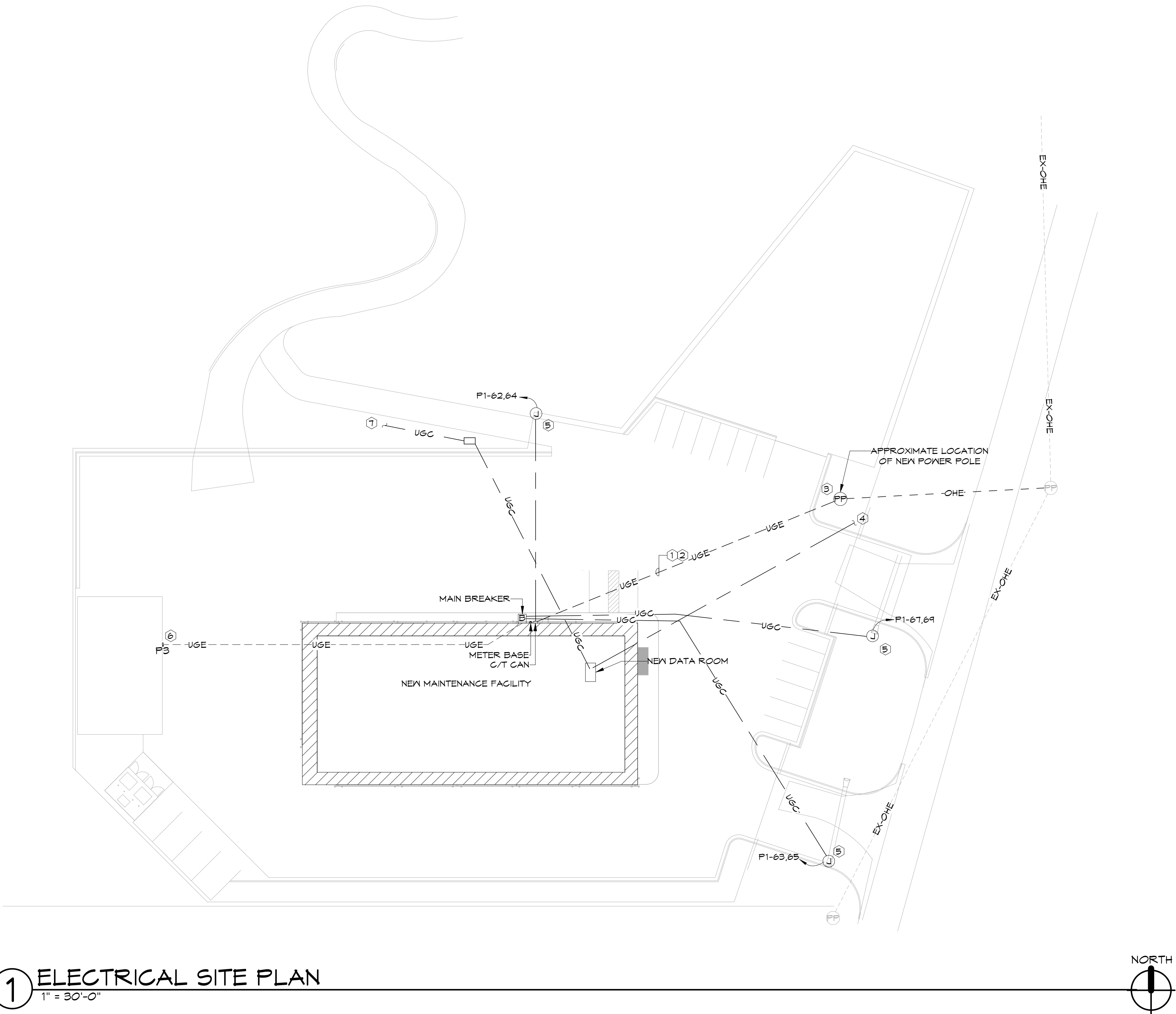

1 ELECTRICAL SITE PLAN  
1" = 30'-0"

NOTES:  
REFER TO SHEET E1.1 FOR ELECTRICAL LEGEND AND NOTES. REFER TO SHEET E3.1 FOR ELECTRICAL DETAILS. REFER TO SHEET E5.1 FOR ELECTRICAL SCHEDULES.

HSAEngineering

501 / 327 / 5757 office

1150 Bob Courtway Drive  
Conway, Arkansas 72032

HSAConsultants.com

HSA JOB # 23-112

LEWIS  
ARCHITECTS  
ENGINEERS

ELLIOTT • MCMORRAN • VADEN  
RAGSDALE • WOODWARD • INCORPORATED  
501 223 9302 • WWW.LEWMVRW.COM

MAINTENANCE BUILDING  
NATIONAL PARK COLLEGE  
HOT SPRINGS, ARKANSAS

DATE:	09-06-2023
PROJECT NO:	23058
DRAWN BY:	AKR
REVISION:	1 9.13.2023
	2 10.27.2023

ES1.0

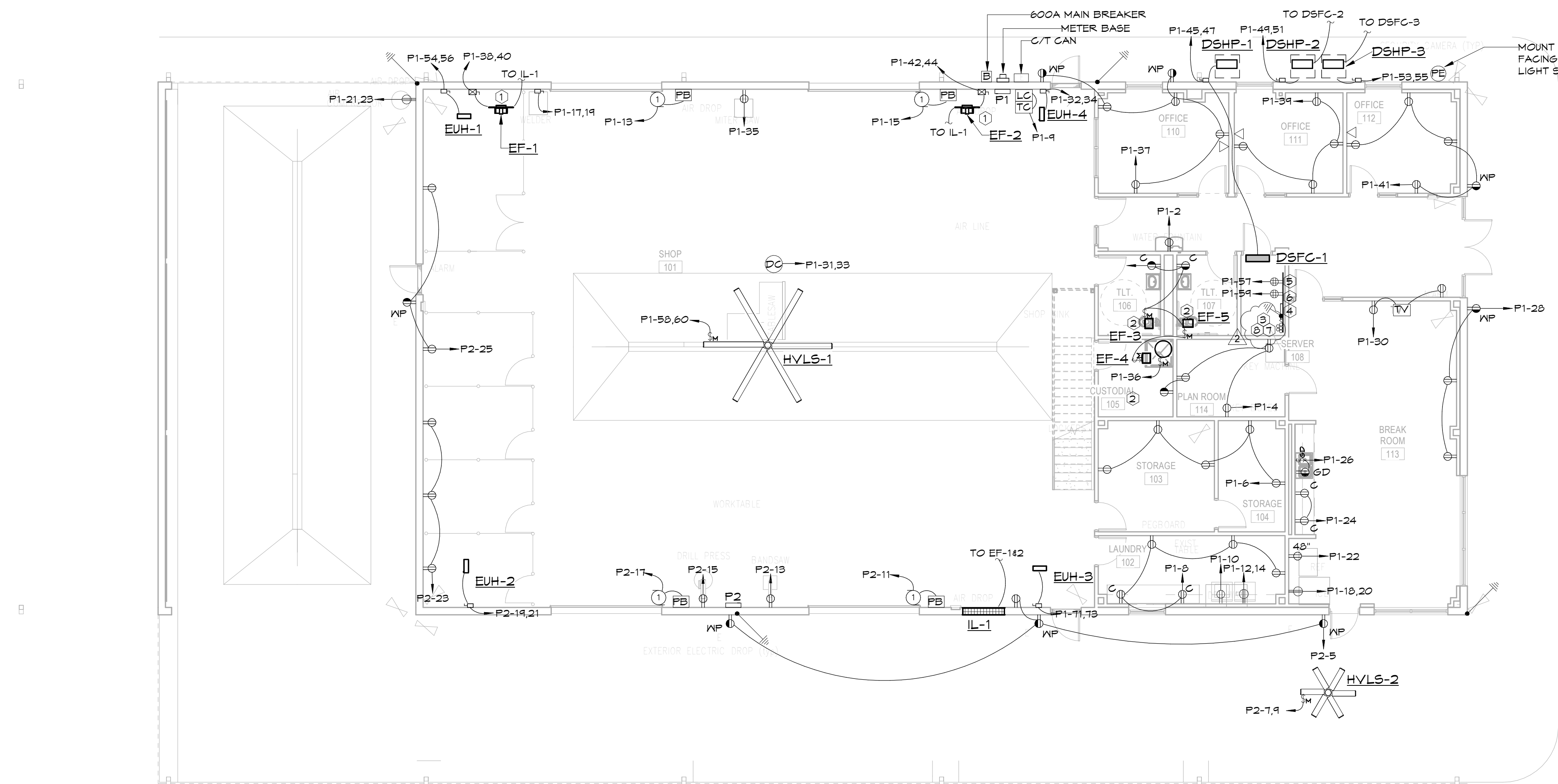

**1 POWER PLAN**  
1/8" = 1'-0"

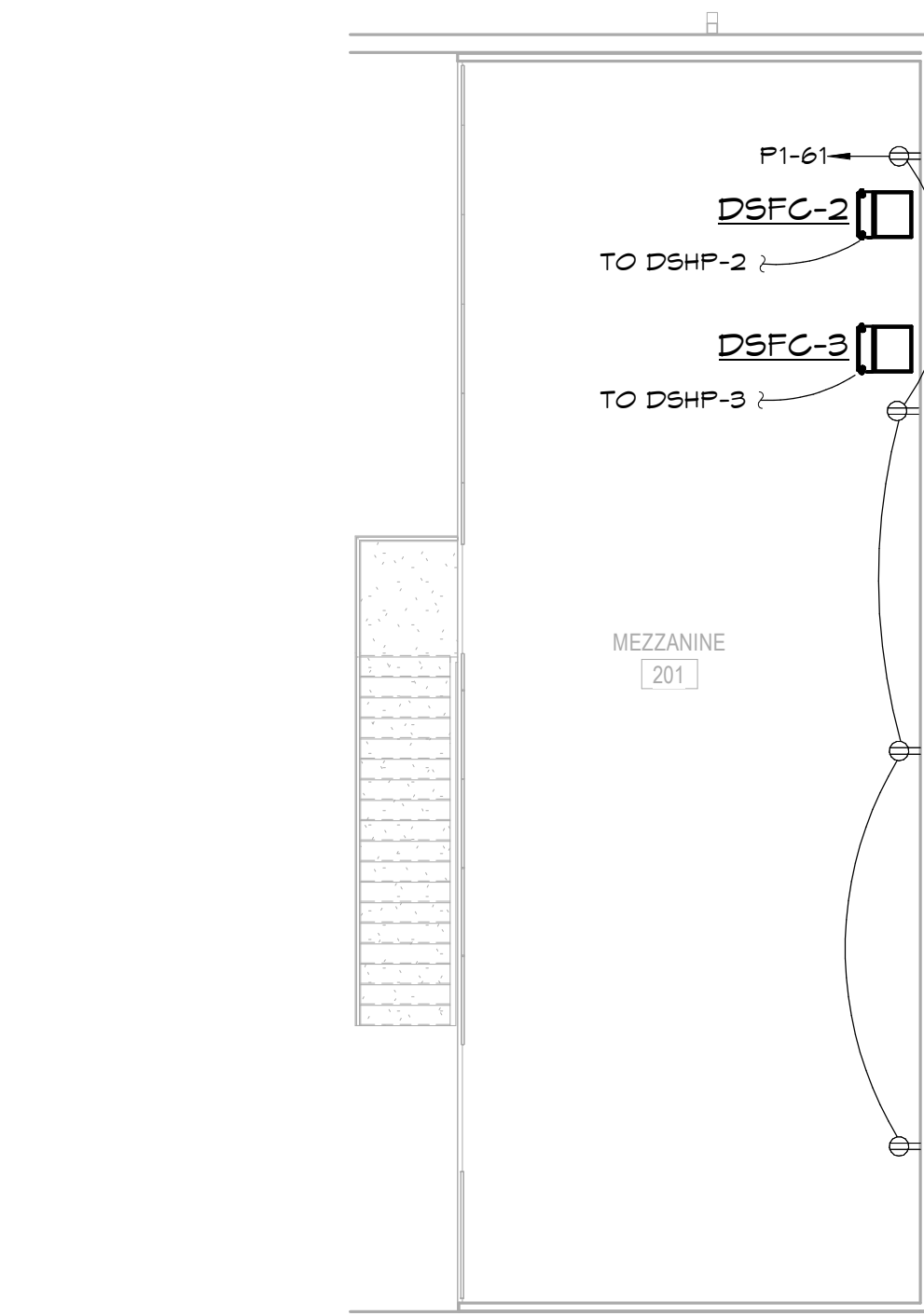

**2 MEZZANINE POWER PLAN**  
1/8" = 1'-0"



### KEYED POWER NOTES

- 1 ELECTRICAL CONTRACTOR SHALL INTERLOCK INTAKE LOUVER (IL-1) MOTOR WITH SWITCH IN JANITORS CLOSET AND EXHAUST FAN EF-142. WHEN THE SWITCH IS TURNED ON THE INTAKE LOUVER SHALL OPEN AND THE EXHAUST FAN SHALL TURN ON VIA LIMIT SWITCH ON INTAKE LOUVER. WHEN THE SWITCH IS TURNED OFF THE INTAKE LOUVER SHALL CLOSE AND THE EXHAUST FAN SHALL TURN OFF. WIRE PER MANUFACTURERS RECOMMENDATIONS. PROVIDE CONTROL POWER FROM CLOSEST RECEPTACLE CIRCUIT.
- 2 EXHAUST FAN TO BE INTERLOCKED WITH LIGHTS IN ROOM.
- 3 INSTALL 2-2" CONDUITS TO UTILITY EASEMENT AT POWER POLE, REFERENCE ELECTRICAL SITE PLAN ES1.0 FOR MORE INFORMATION.
- 4 PROVIDE 1/4" X 20" X 4" GROUNDING BAR. INSTALL A #1/0 COPPER GROUND WIRE FROM GROUND BAR TO ELECTRICAL SERVICE GROUNDING ELECTRODE. LEAVE 5' TAIL.
- 5 3/4" FIRE RATED PLYWOOD BACKBOARD TYPICAL ALL WALLS IN SPACE. B.O. BAND AT 24" A.F.F.
- 6 CONNECT TO THE ELECTRICAL SERVICE GROUNDING ELECTRODE VIA A #6 COPPER GROUND CONDUCTOR, TYPICAL.
- 7 CONDUITS FOR INCOMING SERVICES FROM EXISTING ADULT EDUCATION BUILDING, REFERENCE ELECTRICAL SITE PLAN ES1.0 FOR MORE INFORMATION.
- 8 PROVIDE A 2" CONDUIT FROM THE IT/SERVER ROOM TO THE NEW RELOCATED BUILDING AT THE WEST END OF THE SITE.